

A Droid 2 of Your Own

In This Chapter

- ▶ Putting your phone together
- ▶ Charging the battery
- ▶ Identifying the phone's pieces parts
- ▶ Taking the phone with you
- ▶ Keeping the phone in one place

No one ever asked what happened to R2D1, the lesser-known little brother of R2D2 from the *Star Wars* films. His real name was *R2D*. That was before the newer, improved R2D2 came along. Once the newer, improved model showed up, R2D became R2D1. He lost his luster and fame after the newer model showed up. That happens to all sorts of Droids all over the universe.

For your phone, the Droid 2 replaces the original Droid, which, as far as I know, is still named Droid and not Droid 1. Getting started with your Droid 2 begins with a basic familiarity of the hardware. This chapter helps you get to know your way around the Droid 2, by identifying its various parts, buttons, and sliding whatnot.

Initial Droid 2 Setup

Though it hasn't happened, it would be neat if your phone rang inside the box just as you were opening it. The ringing would certainly accelerate the tedious process of opening the box. Then imagine how much fun it would be to answer the phone and hear a cheerful yet robotic voice say, "Hello from your new Droid 2!" Yeah, that would be fun. Reality is different, as described in this section.



Looking in the box

Several items come in the Droid 2 box. Even though you've probably opened the box already and its contents are doubtless strewn across your desktop, I suggest that you take a moment to locate and identify each of the following goodies:

- ✓ Droid 2 phone
- ✓ Papers, instructions, warranty, and perhaps a booklet titled *Getting Started* or even *Los Primeros Pasos*
- ✓ The phone's battery, which might already be inside the phone
- ✓ The phone's back (battery) cover
- ✓ Charger/data cable, which is basically a USB cable
- ✓ Charger head, a wall adapter for the charger/data cable



The phone may ship with a clingy, static plastic cover over its screen. Another plastic cover may be clinging to the battery cover. The plastic things tell you where various features are located or how to install the battery. You can remove the plastic at this time.

An additional sheet of plastic may be found by sliding out the Droid 2 keyboard; flip the phone over and remove the plastic from the back of the touchscreen.

In addition to the items described in the preceding list, you might have been given a bonus package of goodies from whoever sold you the phone. If the outfit is classy, you have a handy little tote bag with perhaps the Verizon logo on it. Inside the bag, you might find these items:

- ✓ Smart-looking, leatherette belt-clip phone holster
- ✓ Micro-USB car charger
- ✓ Headphones
- ✓ Even more random pieces of paper

The most important doodad is the phone itself, which might require some assembly before you can use it; refer to the next section for assembly directions.

You can safely set aside all this stuff until you get the phone assembled. I recommend keeping the instructions and other information as long as you own the phone: The phone's box makes an excellent storage place for that stuff — as well as anything else you don't plan to use right away.

If anything is missing or appears to be damaged, contact the folks who sold you the phone.

Installing the phone's battery

Your phone might arrive in a disassembled state. If so, your first duty as a new Droid 2 owner is to install its battery. Your second duty is to charge the battery. Installing the battery is easy, and charging it doesn't require a lightning storm and a kite.

If the nice people who sold you the phone already installed the battery, the phone is ready for charging; see the next section. Otherwise, you can install the battery yourself by following these steps:

- 1. Ensure that the phone is turned off.**

There's no need to follow this step unless you got all excited and already turned on your phone. If so, see Chapter 2 for information on turning off the Droid 2.

- 2. Flip over the phone so that the front (the glassy part) is facing away from you.**

Don't remove the phone's cover when the phone is turned on. You should also disconnect any cables or the headset, if attached.

- 3. If the battery isn't installed, you must remove the cover: Place both thumbs on the center part of the upper back cover.**

Refer to Figure 1-1 for proper thumb placement.

- 4. Gently slide the back cover downward using your thumbs.**

A gentle push is all that's required; feel free to squeeze the phone as you push downward. The back cover slides down a wee bit, about $\frac{1}{8}$ -inch.

- 5. Lift the phone's back cover and set it aside.**



Figure 1-1: Thumb-placement suggestion for removing back cover.

6. If necessary, remove the battery from its plastic cocoon.

You can also remove the back cover from its plastic cocoon. You can also peel the plastic “sticky” from the back cover at this time.

7. Orient the battery so that its metallic contacts are in the upper right corner as you’re looking at the back of the phone.

The battery is shaped like a giant, square mint cookie. The battery doesn’t taste like mint, so please do not eat it.

8. Insert the battery, top edge first, and then lower the bottom edge like you’re closing the lid on a tiny box.

Refer to Figure 1-2 for help in positioning and inserting the battery. The metal contacts on the battery should be on the upper right edge as you insert the battery into the phone, as illustrated in the figure.

When it’s fully inserted, the back of the battery is flush with the back of the phone; it cannot stick up, not one itty bit.

9. Replace the phone’s back cover.

The cover has four prongs that slide into four slots on the back of the phone. Position the cover over the slots and it falls into place. Then slide up the cover with your thumbs until it snaps into place.

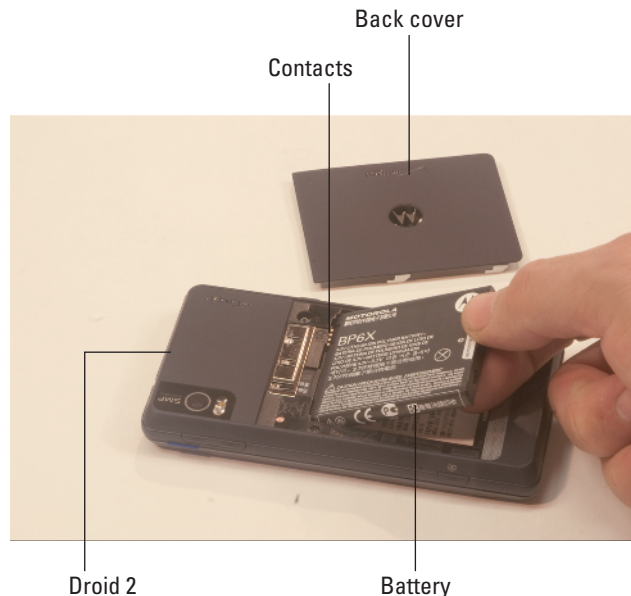

Figure 1-2: Inserting the phone’s battery.

After the battery is installed, the next step is to charge the battery. Continue reading in the next section.

Charging the battery

After inserting the battery into your new phone, the next step is to charge it. It's cinchy:

1. **Connect the charger head (the plug thing) to the charger/data cable.**

They connect only one way.

2. **Plug the charger head and cable into a wall socket.**

3. **Plug the phone into the charger/data cable.**

The charger cord plugs into the micro-USB connector, found at the phone's left side. The connector plugs in only one way.

As the phone charges, the notification light on the phone's front side may light up. When the light is orange-yellow, the phone is charging. When the light is green, the phone is fully charged.

The phone may turn on when you plug it in for a charge. That's okay; but you need to read Chapter 2 to find out what to do the first time the Droid 2 turns on. You also may need to phone your cell provider for additional setup instructions before you turn on the phone.

- ✔ Wait until the notification light turns green before unplugging the phone from its power cable, especially the first time you charge the phone.
- ✔ The notification light uses three colors: amber for charging, green for fully charged, and red for warning that the battery is low.
- ✔ The notification light flashes whenever the phone requires your attention, such as when new email or a text message has been received. See Chapter 3 for information on reviewing notifications.
- ✔ You can use the phone while it's charging.
- ✔ The Droid 2 can use any standard cell phone charger, though I recommend using the equipment that came with the phone or is designed for a Droid 2.
- ✔ You can charge the Droid 2 in your car, using what was once called a "cigarette lighter." Simply ensure that your car cell phone charger features a micro-USB connector and that it's designed for use with the Droid 2.
- ✔ The phone also charges itself when plugged into a computer using either the USB cable that came with the phone or any micro-USB cable attached to a computer. The computer must be on for charging to work.
- ✔ The Droid 2 charges more quickly when it's plugged into the wall as opposed to a computer's USB port or a car adapter.
- ✔ A micro-USB connector is a standard USB connector, but one that features a teensy dongle that plugs into the left side of your Droid 2 phone. The connector has a flat, trapezoid shape, which makes it different from the *mini-USB connector*, which is squat and slightly larger, and used primarily on evil cell phones.



Droid 2 Orientation

Back in the old days, a telephone came with a rotary dial. When you *dialed* a phone, you were literally turning a dial on the phone. When you *hung up* the phone, you placed the headset on a hook. Not so with cell phones. For example, on the Droid 2 you use something called a *touchscreen* to dial the phone. In case you don't know what a touchscreen is, or what many of the other goobers are that festoon your phone, this section explains everything.

Knowing what's what on your phone

Like all other confusing things, the Droid 2 attempts to intimidate you with some new terms for its features, not to mention that you may not be aware of all the hardware features available. Fret not, gentle reader.

Figure 1-3 illustrates the names of all the useful knobs and doodads on the front of your Droid 2 phone. Figure 1-4 illustrates the same things, but for your phone's backside.



Figure 1-3: Your phone's face.



Figure 1-4: Your phone's rump.

The terms referenced in Figures 1-3 and 1-4 are the same ones used elsewhere in this book as well as in whatever scant Droid 2 documentation exists.

In addition to a front and back, your phone has a middle part, which slides out. This teensy keyboard was added to the Droid 2 because of a shipping error from Lilliput. You slide the keyboard out to the left when facing the phone, as illustrated in Figure 1-5.

When you're done using the keyboard, you can slide it back into the phone, as shown in Figure 1-5.

- ✓ The phone's Power button, which turns the phone off or on, is found on top the phone, as shown in Figures 1-3 and 1-4.
- ✓ The main part of the phone is the touchscreen display. You use the touchscreen with one or more of your fingers to control the phone, which is where it gets the name *touchscreen*.
- ✓ The soft buttons appear below the touchscreen, as shown in Figure 1-3. They have no function unless the phone is turned on.
- ✓ Yes, the main microphone is on the bottom of the phone. Even so, it picks up your voice loud and clear. There's no need to hold the phone at an angle for the microphone to work.

- ✓ The phone's volume is adjusted by using the volume buttons on the phone's left side, as shown earlier in Figure 1-3.
- ✓ Sliding out the keyboard wakes up the phone when it has been sleeping. Refer to Chapter 2 for more information on why the phone gets tired and falls asleep.
- ✓ Officially, the keyboard is the *sliding keyboard*. Notice that it's not a true QWERTY keyboard, like the one found on your computer. Chapter 4 covers using the sliding keyboard.
- ✓ When the keyboard is out, the phone's touchscreen display switches to landscape orientation. You can read more about the phone's ability to orient the display into landscape and portrait modes in Chapter 3.

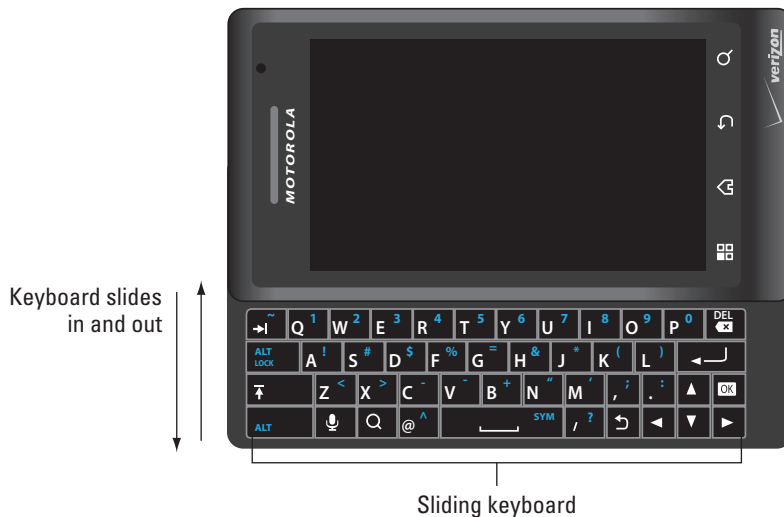

Figure 1-5: The Droid 2 secret keyboard.

Listening with earphones

The Droid 2 most likely didn't come with earphones. That's not a reason to give up on the concept. In fact, the nice people who sold you the Droid 2 might have tossed in a set of earbud-style earphones for you to use. If not, well then, they weren't that nice, were they?

You're probably familiar with the earbud type of earphone: The buds are set into your ears. The sharp, pointy end of the earphones, what you don't want to stick into your ear, plugs into the top of the phone.

Between the earbuds and the sharp, pointy thing is often found a doodle on which a button sits. The button can be used to mute the phone or to start or stop the playback of music when the Droid 2 is in its music-playing mode.

You can also use the doodle button to answer the phone when it rings.

There's usually a teensy hole on the back side of the doodle that serves as the phone's microphone. You can use the earphones as a hands-free headset with the Droid 2. Because I'm half Italian, I love this option.

- ✓ You can purchase any standard cell phone headset for use with the Droid 2.
- ✓ Some headsets feature extra doodle buttons. Those headsets work fine with the Droid 2, though the extra buttons may not do anything specifically with the Droid 2.
- ✓ The earbuds are labeled R for right and L for left. If not, the end with the shorter wire is placed in your right ear.
- ✓ You don't use the earphone's doodle to set the phone's volume, either in a call or while you're listening to music. Instead, the volume is set by using the volume control buttons, found on the side of the phone, as illustrated in Figures 1-3 and 1-4.
- ✓ See Chapter 18 for more information on using your Droid 2 as a portable music player.
- ✓ Be sure to fully insert the earphone connector into the phone. The person you're talking with can't hear you well when the earphones are plugged in only part of the way.
- ✓ You can also use a Bluetooth headset with your phone, to listen to a call or some music. See Chapter 14 for more information on Bluetooth attachments for the Droid 2.
- ✓ Fold the earphones when you don't need them, as opposed to wrapping them in a loop: Put the earbuds and connector in one hand and then pull the wire straight out with the other hand. Fold the wire in half, and then in half again. You can then put the earphones in your pocket or on a tabletop. By folding the wires, you avoid creating one of those Christmas-tree-light wire balls that would otherwise appear.



Exploring your phone's guts

Rarely do you need to examine the intricacies of your phone's innards. Still, unlike other cell phones, the Droid 2 is designed to let you easily access replaceable items inside the unit without having to sneak around behind the manufacturer's back and alerting the warranty police.

Specifically, you need to open your phone for only two reasons:

- ✓ To replace the battery
- ✓ To access the MicroSD memory card

When you need to access those items, you can obey these steps:

1. Turn off your phone.

See the section "Turning off the phone," in Chapter 2, for more information.

2. Flip the phone over.

3. Press down on the upper part of the back cover, using your thumbs as illustrated earlier, in Figure 1-1.

The back cover slides down.

4. Set aside the back cover.

Use Figure 1-6 to identify the phone's battery and the MicroSD memory card.

The battery is removed by lifting its bottom edge: Use your fingernail to lift beneath the label Battery Removal Here, as illustrated in Figure 1-6.

To remove the MicroSD card, pull it downward using the tiny lip at the bottom of the card. It fits in there kind of tightly, so don't be shy about dragging it out. Pull out the card all the way until it's free.

See Chapter 23 for more information on the Droid 2 battery.

When you're done rummaging around inside your phone, you close things up:

5. Set the back cover onto the phone; the little prongs on the back cover fit into four holes on either side of the phone.

The cover fits only one way.

6. Slide the cover up until it snaps into position.

To access the MicroSD card, you must first remove its battery.



Figure 1-6: Stuff inside your phone.

You can turn on the phone again, after the cover is locked into place. See Chapter 2 for information on turning on your phone.



The Droid 2 does not have or use a SIM card. Other cell phones use the SIM card to access the cellular network. The SIM, which stands for Subscriber Identity Module, identifies the phone and does other things you need not care about.

Fashionable Droid 2 Accessories

The Droid 2 has available two accessories you can buy to enhance your mobile communications experience. They are the Multimedia Station and the Car Mount phone holder.

Using the Multimedia Station

In a nutshell, the *Multimedia Station* is a heavy base into which you can set your phone. The station features a USB connection so that the phone can recharge inside the Multimedia Station as well as communicate with a computer.

When the Droid 2 is set inside the Multimedia Station, it runs a special Clock home screen, which displays the current time and provides access to common phone features, as shown in Figure 1-7.



Figure 1-7: The Droid 2 in the Multimedia Station.

The Multimedia Station makes a great home for the phone (see the next section) and can be used as a bedside alarm or as a great way to access the phone when it's deskbound.

- ✓ The Multimedia Station can be purchased at the same place where you obtained your Droid 2 or at any location where cell phone goodies are sold.
- ✓ With the Multimedia Station, you get the handsome, high-tech-looking base and a USB cable, plus a power adapter.
- ✓ See Chapter 19 for more information about using your state-of-the-art cell phone as a digital clock.
- ✓ Chapter 18 covers playing music on the Droid 2.
- ✓ Playing slide shows and managing pictures with the Droid 2 are covered in Chapter 17.

Watching Your Droid 2 in Your Car

There's no point in fumbling with your phone while you're on the road. That's because the Droid 2 comes with a handy car mount. When the car mount is properly assembled, a suction cup on one end of it lets you stick your Droid 2 to any flat surface. Because it's a *car mount*, I assume that you'll suck it to the windshield or dashboard of your favorite auto and not your refrigerator or an elevator door.

When you stick the Droid 2 into the car mount, the phone automatically switches to the Car Home screen, shown in Figure 1-8. You can read more about the Car Home screen in Chapter 3, which is your basic Droid 2 orientation chapter.

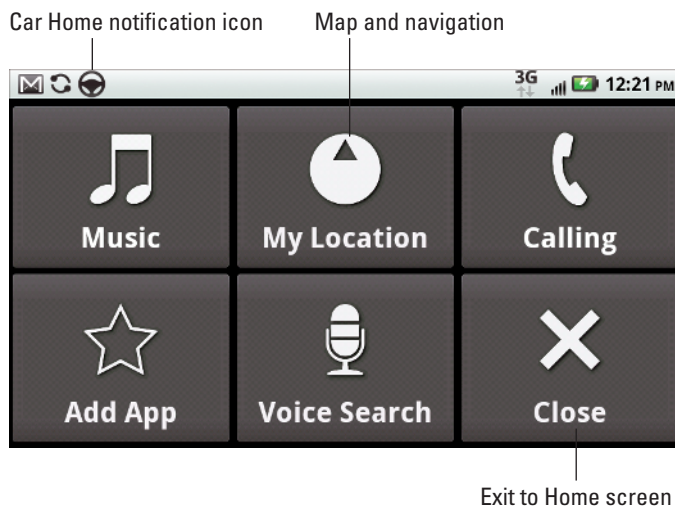

Figure 1-8: The Car Home screen.

The Droid 2 also has a rapid car charger, which may come with the car mount or may be an extra purchase. The rapid car charger is one of those gizmos that plugs into the car's power adapter (née cigarette lighter). The other end of the rapid car charger plugs into the Droid 2, which can be nestled in the car mount or just rattling loose inside your vehicle.



- ✓ Yes, you can use the rapid car charger without having to use the car mount.
- ✓ To make the suction cup on the car mount work properly, you use a hard, smooth surface. An adhesive plastic disk comes with the car mount. Use the disk to ensure that the suction cup has something solid to suck on.

A Home for Your Phone

There was no point in finding a home for your phone back when the Telephone Company bolted the thing to the wall. I remember hunting all over the house for our family's first cordless phone. That was a pain when the batteries were dead and the phone's locator-ring trick didn't work. It was even more of a pain when you just *knew* that the phone was lost in the sofa cushions and Aunt Martha was pulling some zzz's on the couch.

Your Droid 2 lives an untethered existence, so find it a permanent spot — even when you're carrying it around.

Carrying the Droid 2

The compact design of the Droid 2 is perfect for a pocket or even the teensiest of party purses. It's well designed so that you can carry your phone in your pocket or handbag without the fear that something will accidentally turn it on, dial Sri Lanka, and run up a heck of a cell phone bill.

Because the Droid 2 features a proximity sensor, you can even keep the phone in your pocket while you're on a call. The proximity sensor disables the touchscreen, which ensures that nothing accidentally gets touched when you don't want it to be touched.

- ✓ Though it's okay to place the phone somewhere when you're making a call, be careful not to touch the phone's Power button (see Figure 1-3). Doing so may temporarily enable the touchscreen, which can hang up a call, mute the phone, or do any of a number of undesirable things.



- ✓ You can always store the Droid 2 in one of a variety of handsome carrying case accessories, some of which come in fine Naugahyde or leatherette.
- ✓ Don't forget that the phone is in your pocket, especially in your coat or jacket. You might accidentally sit on the phone, or it could fly out when you take off your coat. The worst fate for the Droid 2, or any cell phone, is to take a trip through the wash. I'm sure the phone has nightmares about that happening.

Storing the Droid 2

I recommend that you find a place for your phone when you're not taking it with you. Make the spot consistent: on top of your desk or workstation, in the kitchen, on the nightstand — you get the idea. Phones are as prone to being misplaced as are your car keys and glasses. Consistency is the key to finding your phone.

Then again, your phone does ring, so when you lose it, you can always have someone else call your cell phone to help you locate it.

- ✓ The Multimedia Station makes a handsome, permanent location for your Droid 2.
- ✓ I keep my Droid 2 on my desk, next to my computer. Conveniently, I have the charger plugged into the computer so that I keep the phone plugged in, connected, and charging when I'm not using it.
- ✓ Phones on coffee tables get buried under magazines and often squished when rude people put their feet on the furniture.
- ✓ Avoid putting the Droid 2 in direct sunlight; heat is a bad thing for any electronic gizmo.
- ✓ Do not put your phone in the laundry (see the preceding section). See Chapter 23 for information on properly cleaning the phone.

