

Chapter 1

Introducing Excel Tables

In This Chapter

- ▶ Figuring out tables
- ▶ Building tables
- ▶ Analyzing tables with simple statistics
- ▶ Sorting tables
- ▶ Discovering the difference between using AutoFilter and filtering

First things first. I need to start my discussion of using Excel for data analysis by introducing Excel tables, or what Excel used to call *lists*. Why? Because, except in the simplest of situations, when you want to analyze data with Excel, you want that data stored in a table. In this chapter, I discuss what defines an Excel table; how to build, analyze, and sort a table; and why using filters to create a subtable is useful.

What Is a Table and Why Do I Care?

A table is, well, a list. This definition sounds simplistic, I guess. But take a look at the simple table shown in Figure 1-1. This table shows the items that you might shop for at a grocery store on the way home from work.



As I mention in the Introduction of this book, many of the Excel workbooks that you see in the figures of this book are available for download from this book's companion website. For more on how to access the companion website, see the Introduction.

Commonly, tables include more information than Figure 1-1 shows. For example, take a look at the table shown in Figure 1-2. In column A, for example, the table names the store where you might purchase the item. In column C, this expanded table gives the quantity of some item that you need. In column D, this table provides a rough estimate of the price.

Figure 1-1:
A table:
Start out
with the
basics.

| | A | B | C | D | E | F | G | H | I | J | K | L | M | N | O | P | Q | R | S | T |
|----|-----------|---|---|---|---|---|---|---|---|---|---|---|---|---|---|---|---|---|---|---|
| 1 | Bread | | | | | | | | | | | | | | | | | | | |
| 2 | Coffee | | | | | | | | | | | | | | | | | | | |
| 3 | Tomatoes | | | | | | | | | | | | | | | | | | | |
| 4 | Tea | | | | | | | | | | | | | | | | | | | |
| 5 | Ice Cream | | | | | | | | | | | | | | | | | | | |
| 6 | Butter | | | | | | | | | | | | | | | | | | | |
| 7 | Milk | | | | | | | | | | | | | | | | | | | |
| 8 | Lamb | | | | | | | | | | | | | | | | | | | |
| 9 | Chicken | | | | | | | | | | | | | | | | | | | |
| 10 | | | | | | | | | | | | | | | | | | | | |
| 11 | | | | | | | | | | | | | | | | | | | | |
| 12 | | | | | | | | | | | | | | | | | | | | |
| 13 | | | | | | | | | | | | | | | | | | | | |
| 14 | | | | | | | | | | | | | | | | | | | | |
| 15 | | | | | | | | | | | | | | | | | | | | |
| 16 | | | | | | | | | | | | | | | | | | | | |
| 17 | | | | | | | | | | | | | | | | | | | | |
| 18 | | | | | | | | | | | | | | | | | | | | |
| 19 | | | | | | | | | | | | | | | | | | | | |
| 20 | | | | | | | | | | | | | | | | | | | | |
| 21 | | | | | | | | | | | | | | | | | | | | |
| 22 | | | | | | | | | | | | | | | | | | | | |
| 23 | | | | | | | | | | | | | | | | | | | | |
| 24 | | | | | | | | | | | | | | | | | | | | |
| 25 | | | | | | | | | | | | | | | | | | | | |

Figure 1-2:
A grocery
list for
the more
serious
shopper . . .
like me.

| | A | B | C | D | E | F | G | H | I | J | K | L | M | N | O | P | Q | R | S | T |
|----|--------------|-----------|----------|-------|---|---|---|---|---|---|---|---|---|---|---|---|---|---|---|---|
| 1 | Store | Item | Quantity | Price | | | | | | | | | | | | | | | | |
| 2 | Sams Grocery | Bread | 2 | 1 | | | | | | | | | | | | | | | | |
| 3 | Sams Grocery | Coffee | 1 | 8 | | | | | | | | | | | | | | | | |
| 4 | Sams Grocery | Tomatoes | 1 | 1 | | | | | | | | | | | | | | | | |
| 5 | Sams Grocery | Tea | 1 | 5 | | | | | | | | | | | | | | | | |
| 6 | Hughes Dairy | Ice Cream | 1 | 5 | | | | | | | | | | | | | | | | |
| 7 | Hughes Dairy | Butter | 1 | 3 | | | | | | | | | | | | | | | | |
| 8 | Hughes Dairy | Milk | 2 | 2 | | | | | | | | | | | | | | | | |
| 9 | Butcherhans | Lamb | 4 | 7 | | | | | | | | | | | | | | | | |
| 10 | Butcherhans | Chicken | 1 | 5 | | | | | | | | | | | | | | | | |
| 11 | | | | | | | | | | | | | | | | | | | | |
| 12 | | | | | | | | | | | | | | | | | | | | |
| 13 | | | | | | | | | | | | | | | | | | | | |
| 14 | | | | | | | | | | | | | | | | | | | | |
| 15 | | | | | | | | | | | | | | | | | | | | |
| 16 | | | | | | | | | | | | | | | | | | | | |
| 17 | | | | | | | | | | | | | | | | | | | | |
| 18 | | | | | | | | | | | | | | | | | | | | |
| 19 | | | | | | | | | | | | | | | | | | | | |
| 20 | | | | | | | | | | | | | | | | | | | | |
| 21 | | | | | | | | | | | | | | | | | | | | |
| 22 | | | | | | | | | | | | | | | | | | | | |
| 23 | | | | | | | | | | | | | | | | | | | | |
| 24 | | | | | | | | | | | | | | | | | | | | |
| 25 | | | | | | | | | | | | | | | | | | | | |

An Excel table usually looks more like the list shown in Figure 1-2. Typically, the table enumerates rather detailed descriptions of numerous items. But a table in Excel, after you strip away all the details, essentially resembles the expanded grocery-shopping list shown in Figure 1-2.

Let me make a handful of observations about the table shown in Figure 1-2. First, each column shows a particular sort of information. In the parlance of database design, each *column* represents a field. Each *field* stores the same sort of information. Column A, for example, shows the store where some item can be purchased. (You might also say that this is the Store field.) Each piece of information shown in column A — the Store field — names a store: Sams Grocery, Hughes Dairy, and Butchermans.

The first row in the Excel worksheet provides field names. For example, in Figure 1-2, row 1 names the four fields that make up the list: Store, Item, Quantity, and Price. You always use the first row, called the *header row*, of an Excel list to name, or identify, the fields in the list.

Starting in row 2, each row represents a record, or item, in the table. A *record* is a collection of related fields. For example, the record in row 2 in Figure 1-2 shows that at Sams Grocery, you plan to buy two loaves of bread for a price of \$1 each. (Bear with me if these sample prices are wildly off; I usually don't do the shopping in my household.)

Row 3 shows or describes another item, coffee, also at Sams Grocery, for \$8. In the same way, the other rows of the super-sized grocery list show items that you will buy. For each item, the table identifies the store, the item, the quantity, and the price.



Something to understand about Excel tables

An Excel table is a *flat-file database*. That flat-file-ish-ness means that there's only one table in the database. And the flat-file-ish-ness also means that each record stores every bit of information about an item.

In comparison, popular desktop database applications such as Microsoft Access are *relational databases*. A relational database stores information more efficiently. And the most striking way in which this efficiency appears is that you don't see lots of duplicated or redundant information in a relational database. In a relational database, for example, you might not see Sams

Grocery appearing in cells A2, A3, A4, and A5. A relational database might eliminate this redundancy by having a separate table of grocery stores.

This point might seem a bit esoteric; however, you might find it handy when you want to grab data from a relational database (where the information is efficiently stored in separate tables) and then combine all this data into a super-sized flat-file database in the form of an Excel list. In Chapter 2, I discuss how to grab data from external databases.

Building Tables

You build a table that you want to later analyze by using Excel in one of two ways:

- ✓ Export the table from a database.
- ✓ Manually enter items into an Excel workbook.

Exporting from a database

The usual way to create a table to use in Excel is to export information from a database. Exporting information from a database isn't tricky. However, you need to reflect a bit on the fact that the information stored in your database is probably organized into many separate tables that need to be combined into a large flat-file database or table.

In Chapter 2, I describe the process of exporting data from the database and then importing this data into Excel so it can be analyzed. Hop over to that chapter for more on creating a table by exporting and then importing.



Even if you plan to create your tables by exporting data from a database, however, read on through the next paragraphs of this chapter. Understanding the nuts and bolts of building a table makes exporting database information to a table and later using that information easier.

Building a table the hard way

The other common way to create an Excel table (besides exporting from a relational database) is to do it manually. For example, you can create a table in the same way that I create the grocery list shown in Figure 1-2. You first enter field names into the first row of the worksheet and then enter individual records, or items, into the subsequent rows of the worksheet. When a table isn't too big, this method is very workable. This is the way, obviously, that I created the table shown in Figure 1-2.

Building a table the semi-hard way

To create a table manually, you typically want to enter the field names into row 1, select those field names and the empty cells of row 2, and then choose Insert→Table. Why? The Table command tells Excel, right from the get-go, that you're building a table. But let me show you how this process works.

Manually adding records into a table

To manually create a list by using the Table command, follow these steps:

1. Identify the fields in your list.

To identify the fields in your list, enter the field names into row 1 in a blank Excel workbook. For example, Figure 1-3 shows a workbook fragment. Cells A1, B1, C1, and D1 hold field names for a simple grocery list.

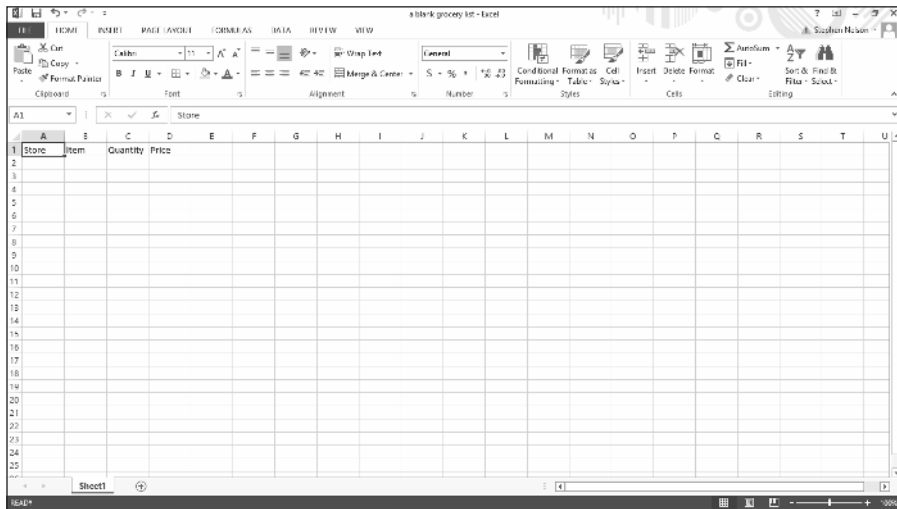

Figure 1-3:
The start of
something
important.

2. Select the Excel table.

The Excel table must include the row of the field names and at least one other row. This row might be blank or it might contain data. In Figure 1-3, for example, you can select an Excel list by dragging the mouse from cell A1 to cell D2.

3. Click the Insert tab and then its Table button to tell Excel that you want to get all official right from the start.

If Excel can't figure out which row holds your field names, Excel displays the dialog box shown in Figure 1-4. Check the My Table Has Headers check box to confirm that the first row in your range selection holds the field names. When you click OK, Excel re-displays the worksheet set up as a table, as shown in Figure 1-5.

Figure 1-4:
Excel tries
to figure out
what you're
doing.

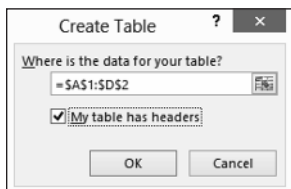
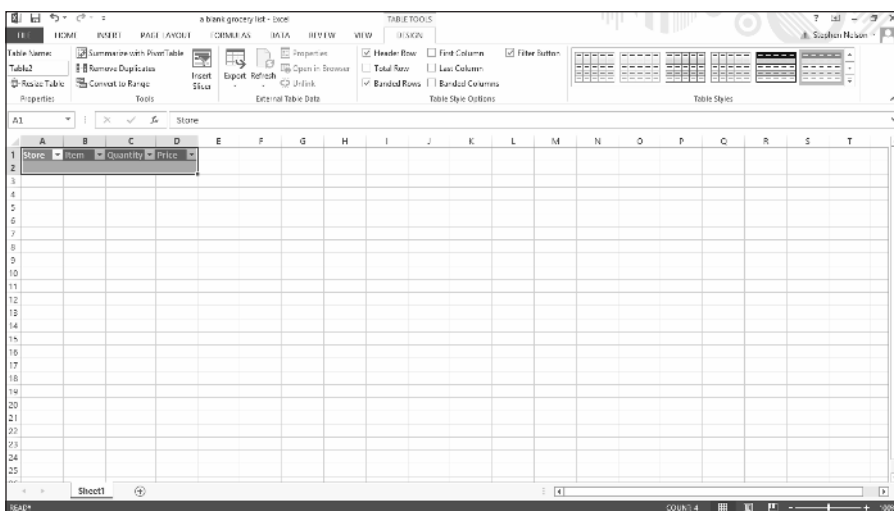

Figure 1-5:
Enter your
table rows
into nicely
colored
rows.



4. Describe each record.

To enter a new record into your table, fill in the next empty row. For example, use the Store text box to identify the store where you purchase each item. Use the — oh, wait a minute here. You don't need me to tell you that the store name goes into the Store column, do you? You can figure that out. Likewise, you already know what bits of information go into the Item, Quantity, and Price column, too, don't you? Okay. Sorry.

5. Store your record in the table.

Click the Tab or Enter button when you finish describing some record or item that goes onto the shopping list. Excel adds another row to the table so that you can add another item. Excel shows you which rows and columns are part of the table by using color.

Some table-building tools

Excel includes an AutoFill feature, which is particularly relevant for table building. Here's how AutoFill works: Enter a label into a cell in a column where it's already been entered before, and Excel guesses that you're entering the same thing again. For example, if you enter the label **Sams Grocery** in cell A2 and then begin to type **Sams Grocery** in cell A3, Excel guesses that you're entering **Sams Grocery** again and finishes typing the label for you. All you need to do to accept Excel's guess is press Enter. Check it out in Figure 1-6.

Figure 1-6:
A little
workbook
fragment,
compliments
of AutoFill.

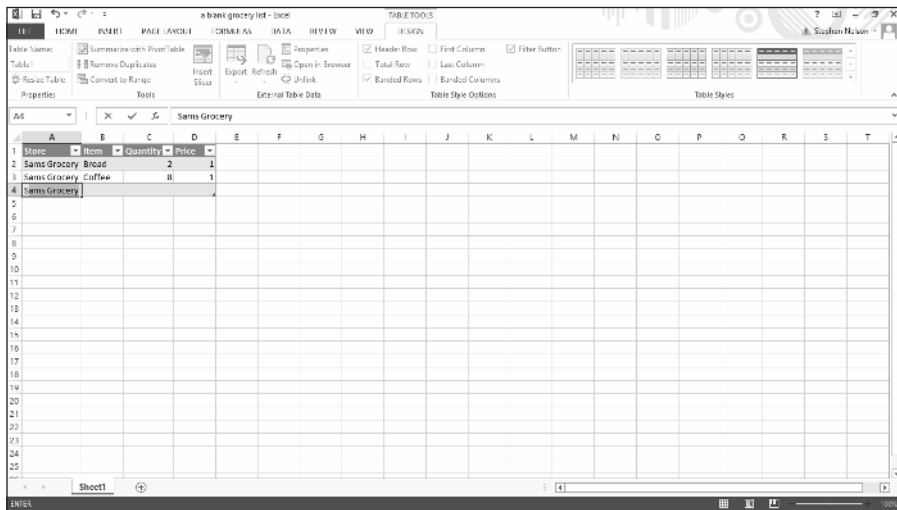

Excel also provides a Fill command that you can use to fill a range of cells — including the contents of a column in an Excel table — with a label or value. To fill a range of cells with the value that you've already entered in another cell, you drag the Fill Handle down the column. The Fill Handle is the small plus sign (+) that appears when you place the mouse cursor over the lower-right corner of the active cell. In Figure 1-7, I use the Fill Handle to enter **Sams Grocery** into the range A5:A12.

Figure 1-7:
Another
little
workbook
fragment,
complimenting
the
Fill Handle.

| Item | Item | Quantity | Price |
|--------------|--------|----------|-------|
| Sams Grocery | Bread | 2 | 1 |
| Sams Grocery | Coffee | 1 | 1 |
| Sams Grocery | Coffee | | |
| Sams Grocery | Coffee | | |
| Sams Grocery | Cotto | | |
| Sams Grocery | Cotto | | |
| Sams Grocery | Cotto | | |
| Sams Grocery | Cotto | | |
| Sams Grocery | Cotto | | |
| Sams Grocery | Cotto | | |
| Sams Grocery | Cotto | | |

Analyzing Table Information

Excel provides several handy, easy-to-use tools for analyzing the information that you store in a table. Some of these tools are so easy and straightforward that they provide a good starting point.

Simple statistics

Look again at the simple grocery list table that I mention earlier in the section, “What Is a Table and Why Do I Care?” See Figure 1-8 for this grocery list as I use this information to demonstrate some of the quick-and-dirty statistical tools that Excel provides.

One of the slickest and quickest tools that Excel provides is the ability to effortlessly calculate the sum, average, count, minimum, and maximum of values in a selected range. For example, if you select the range C2 to C10 in Figure 1-8, Excel calculates an average, counts the values, and even sums the quantities, displaying this useful information in the status bar. In Figure 1-8, note the information on the status bar (the lower edge of the workbook):

Average: 1.555555556 Count: 9 Sum: 14

This indicates that the average order quantity is (roughly) 1.5, that you’re shopping for 9 different items, and that the grocery list includes 14 items: Two loaves of bread, one can of coffee, one tomato, one box of tea, and so on.

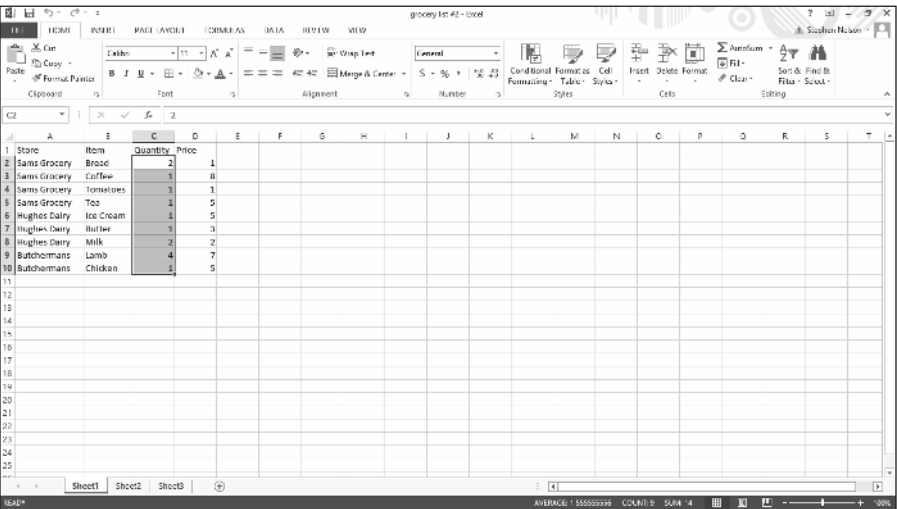

Figure 1-8: Start at the beginning.

The big question here, of course, is whether, with 9 different products but a total count of 14 items, you’ll be able to go through the express checkout line. But that information is irrelevant to our discussion. (You, however, might want to acquire another book I’m planning, *Grocery Shopping For Dummies*.)

You aren’t limited, however, to simply calculating averages, counting entries, and summing values in your list. You can also calculate other statistical measures.

To perform some other statistical calculation of the selected range list, right-click the status bar. When you do, Excel displays a pop-up Status Bar Configuration menu. Near the bottom of that menu bar, Excel provides six statistical measures that you can add to or remove from the Status Bar: Average, Count, Count Numerical, Maximum, Minimum, and Sum. In Table 1-1, I describe each of these statistical measures briefly, but you can probably guess what they do. Note that if a statistical measure is displayed on the Status Bar, Excel places a check mark in front of the measure on the Status Bar Confirmation menu. To remove the statistical measure, select the measure.

Table 1-1 Quick Statistical Measures Available on the Status Bar

| <i>Option</i> | <i>What It Does</i> |
|-----------------|---|
| Count | Tallies the cells that hold labels, values, or formulas. In other words, use this statistical measure when you want to count the number of cells that are <i>not</i> empty. |
| Count Numerical | Tallies the number of cells in a selected range that hold values or formulas. |
| Maximum | Finds the largest value in the selected range. |
| Minimum | Finds the smallest value in the selected range. |
| Sum | Adds up the values in the selected range. |

No kidding, these simple statistical measures are often all you need to gain wonderful insights into data that you collect and store in an Excel table. By using the example of a simple, artificial grocery list, the power of these quick statistical measures doesn't seem all that earthshaking. But with real data, these measures often produce wonderful insights.

In my own work as a technology writer, for example, I first noticed the deflation in the technology bubble a decade ago when the total number of computer books that one of the larger distributors sold — information that appeared in an Excel table — began dropping. Sometimes, simply adding, counting, or averaging the values in a table gives extremely useful insights.

Sorting table records

After you place information in an Excel table, you'll find it very easy to sort the records. You can use the Sort & Filter button's commands.

Using the Sort buttons

To sort table information by using a Sort & Filter button's commands, click in the column you want to use for your sorting. For example, to sort a grocery list like the one shown in Figure 1-8 by the store, click a cell in the Store column.

After you select the column you want to use for your sorting, click the Sort & Filter button and choose the Sort A to Z command from the menu Excel displays to sort table records in ascending, A-to-Z order using the selected column's information. Alternatively, choosing the Sort Z to A command from the menu Excel displays sort table records in descending, Z-to-A order using the selected column's information.

Using the Custom Sort dialog box

When you can't sort table information exactly the way you want by using the Sort A to Z and Sort Z to A commands, use the Custom Sort command.

To use the Custom Sort command, follow these steps:

1. **Click a cell inside the table.**
2. **Click the Sort & Filter button and choose the Sort command from the Sort & Filter menu.**

Excel displays the Sort dialog box, as shown in Figure 1-9.

In Excel 2007 and Excel 2010, choose the Data↔Custom Sort command to display the Sort dialog box.



Figure 1-9:
Set sort
parameters
here.

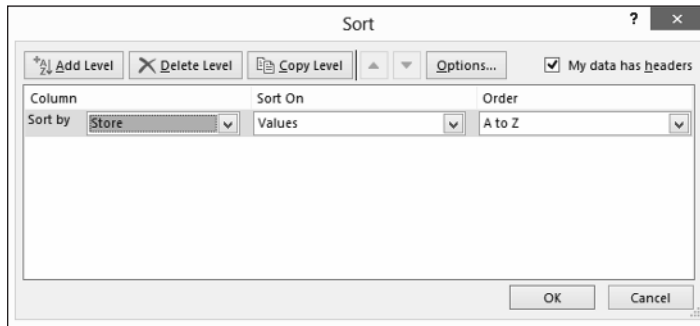

3. **Select the first sort key.**

Use the Sort By drop-down list to select the field that you want to use for sorting. Next, choose what you want to use for sorting: values, cell colors, font colors, or icons. Probably, you're going to sort by values, in which case, you'll also need to indicate whether you want records arranged in ascending or descending order by selecting either the ascending A to Z or descending Z to A entry from the Order box. Ascending order, predictably, alphabetizes labels and arranges values in smallest-value-to-largest-value order. Descending order arranges labels in reverse alphabetical order and values in largest-value-to-smallest-value order. If you sort by color or icons, you need to tell Excel how it should sort the colors by using the options that the Order box provides.



Typically, you want the key to work in ascending or descending order. However, you might want to sort records by using a chronological sequence, such as Sunday, Monday, Tuesday, and so on, or January, February, March, and so forth. To use one of these other sorting options, select the custom list option from the Order box and then choose one of these other ordering methods from the dialog box that Excel displays.

4. (Optional) Specify any secondary keys.

If you want to sort records that have the same primary key with a secondary key, click the Add Level button and then use the next row of choices from the Then By drop-down lists to specify which secondary keys you want to use. If you add a level that you later decide you don't want or need, click the sort level and then click the Delete Level button. You can also duplicate the selected level by clicking Copy Level. Finally, if you do create multiple sorting keys, you can move the selected sort level up or down in significance by clicking the Move Up or Move Down buttons.

Note: The Sort dialog box also provides a My Data Has Headers check box that enables you to indicate whether the worksheet range selection includes the row and field names. If you've already told Excel that a worksheet range is a table, however, this check box is disabled.

5. (Really optional) Fiddle-faddle with the sorting rules.

If you click the Options button in the Sort dialog box, Excel displays the Sort Options dialog box, shown in Figure 1-10. Make choices here to further specify how the first key sort order works.

Figure 1-10:
Sorting out
your sorting
options.



For a start, the Sort Options dialog box enables you to indicate whether case sensitivity (uppercase versus lowercase) should be considered.

You can also use the Sort Options dialog box to tell Excel that it should sort rows instead of columns or columns instead of rows. You make this specification by using either Orientation radio button: Sort Top to Bottom or Sort Left to Right. Click OK when you've sorted out your sorting options.

6. Click OK.

Excel then sorts your list.

Using AutoFilter on a table

Excel provides an AutoFilter command that's pretty cool. When you use AutoFilter, you produce a new table that includes a subset of the records from your original table. For example, in the case of a grocery list table, you could use AutoFilter to create a subset that shows only those items that you'll purchase at Butcherhans or a subset table that shows only those items that cost more than, say, \$2.

To use AutoFilter on a table, take these steps:

1. Select your table.

Select your table by clicking one of its cells. By the way, if you haven't yet turned the worksheet range holding the table data into an "official" Excel table, select the table and then choose the Insert tab's Table command.

2. (Perhaps unnecessary) Choose the AutoFilter command.

When you tell Excel that a particular worksheet range represents a table, Excel turns the header row, or row of field names, into drop-down lists. Figure 1-11 shows this. If your table doesn't include these drop-down lists, add them by clicking the Sort & Filter button and choosing the Filter command. Excel turns the header row, or row of field names, into drop-down lists.

Tip: In Excel 2007 and Excel 2010, you choose the Data>Filter command to tell Excel you want to AutoFilter.



Drop-down list boxes appear when you turn on AutoFiltering.

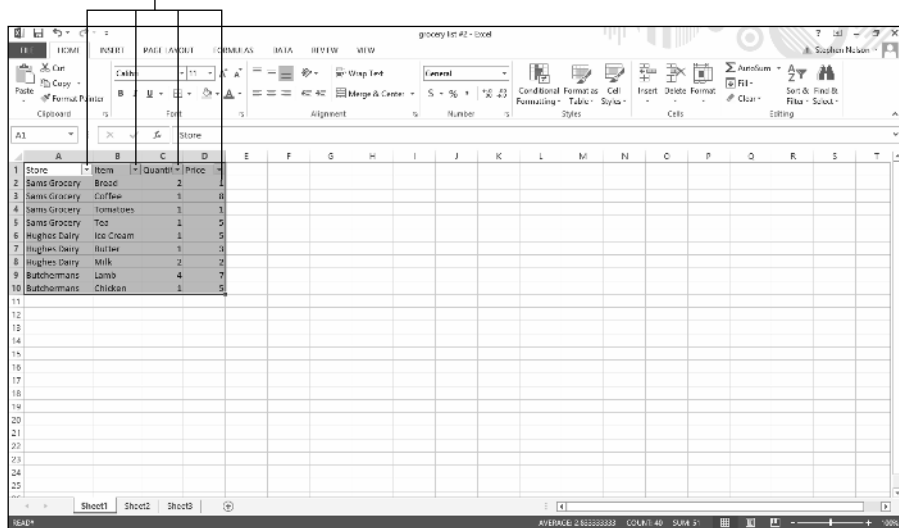

Figure 1-11:
How an
Excel
table looks
after using
AutoFilter.

3. Use the drop-down lists to filter the list.

Each of the drop-down lists that now make up the header row can be used to filter the list.

To filter the list by using the contents of some field, select (or open) the drop-down list for that field. For example, in the case of the little workbook shown in Figure 1-11, you might choose to filter the grocery list so that it shows only those items that you'll purchase at Sams Grocery. To do this, click the Store drop-down list down-arrow button. When you do, Excel displays a menu of table sorting and filtering options. To see just those records that describe items you've purchased at Sams Grocery, select Sams Grocery. Figure 1-12 shows the filtered list with just the Sams Grocery items visible.

If your eyes work better than mine do, you might even be able to see a little picture of a funnel on the Store column's drop-down list button. This icon tells you the table is filtered using the Store column's data.

Figure 1-12:
Sams and
Sams alone.

| A | B | C | D |
|---|--------------|----------|----------------|
| 1 | Store | Item | Quantity Price |
| 2 | Sams Grocery | Bread | 2 1 |
| 3 | Sams Grocery | CatFlea | 1 8 |
| 4 | Sams Grocery | Tomatoes | 3 3 |
| 5 | Sams Grocery | Tea | 1 5 |

To unfilter the table, open the Store drop-down list and choose Select All.

If you're filtering a table using the table menu, you can also sort the table's records by using table menu commands. Sort A to Z sorts the records (filtered or not) in ascending order. Sort Z to A sorts the records (again, filtered or not) in descending order. Sort by Color lets you sort according to cell colors.

Undoing a filter

To remove an AutoFilter, display the table menu by clicking a drop-down list's button. Then choose the Clear Filter command from the table menu.

Turning off filter

The AutoFilter command is actually a toggle switch. When filtering is turned on, Excel turns the header row of the table into a row of drop-down lists. When you turn off filtering, Excel removes the drop-down list functionality. To turn off filtering and remove the Filter drop-down lists, simply click the Sort & Filter button and choose the Filter command (or in Excel 2007 or Excel 2010, choose Data⇨Filter command).

Using the custom AutoFilter

You can also construct a custom AutoFilter. To do this, select the Text Filter command from the table menu and choose one of its text filtering options. No matter which text filtering option you pick, Excel displays the Custom AutoFilter dialog box, as shown in Figure 1-13. This dialog box enables you to specify with great precision what records you want to appear on your filtered list.

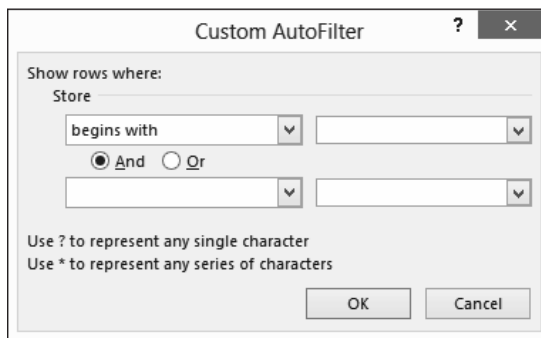

Figure 1-13:
The Custom
AutoFilter
dialog box.

To create a custom AutoFilter, take the following steps:

- 1. Turn on the Excel Filters.**

As I mention earlier in this section, filtering is probably already on because you've created a table. However, if filtering isn't turned on, select the table, click the Sort & Filter button, and choose Filter. Or in Excel 2007 or Excel 2010, simply choose Data⇨Filter.

2. Select the field that you want to use for your custom AutoFilter.

To indicate which field you want to use, open the filtering drop-down list for that field to display the table menu, select Text Filters, and then select a filtering option. When you do this, Excel displays the Custom AutoFilter dialog box. (Refer to Figure 1-13.)

3. Describe the AutoFilter operation.

To describe your AutoFilter, you need to identify (or confirm) the filtering operation and the filter criteria. Use the left-side set of drop-down lists to select a filtering option. For example, in Figure 1-14, the filtering option selected in the first Custom AutoFilter set of dialog boxes is Begins With. If you open this drop-down list, you'll see that Excel provides a series of filtering options:

- Begins With
- Equals
- Does Not Equal
- Is Greater Than or Equal To
- Is Less Than
- Is Less Than or Equal To
- Begins With
- Does Not Begin With
- Ends With
- Does Not End With
- Contains
- Does Not Contain

The key thing to be aware of is that you want to pick a filtering operation that, in conjunction with your filtering criteria, enables you to identify the records that you want to appear in your filtered list. Note that Excel initially fills in the filtering option that matches the command you selected on the Text Filter submenu, but you can change this initial filtering selection to something else.



In practice, you won't want to use precise filtering criteria. Why? Well, because your list data will probably be pretty dirty. For example, the names of stores might not match perfectly because of misspellings. For this reason, you'll find filtering operations based on Begins With or Contains and filtering criteria that use fragments of field names or ranges of values most valuable.

4. Describe the AutoFilter filtering criteria.

After you pick the filtering option, you describe the filtering criteria by using the right-hand drop-down list. For example, if you want to filter records that equal *Sams Grocery* or, more practically, that begin with the word *Sams*, you enter **Sams** into the right-hand box. Figure 1-14 shows this custom AutoFilter criterion.

You can use more than one AutoFilter criterion. If you want to use two custom AutoFilter criteria, you need to indicate whether the criteria are both applied together or are applied independently. You select either the And or Or radio button to make this specification.

5. Click OK.

Excel then filters your table according to your custom AutoFilter.

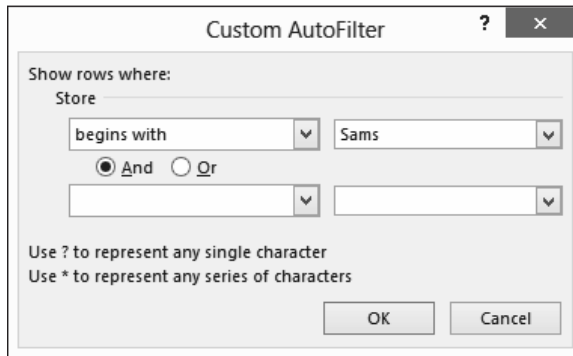

Figure 1-14:
Setting up
a custom
AutoFilter.

Filtering a filtered table

You can filter a filtered table. What this often means is that if you want to build a highly filtered table, you will find your work easiest if you just apply several sets of filters.

If you want to filter the grocery list to show only the most expensive items that you purchase at Sams Grocery, for example, you might first filter the table to show items from Sams Grocery only. Then, working with this filtered table, you would further filter the table to show the most expensive items or only those items with the price exceeding some specified amount.

The idea of filtering a filtered table seems, perhaps, esoteric. But applying several sets of filters often reduces a very large and nearly incomprehensible table to a smaller subset of data that provides just the information that you need.



Building on the earlier section “Using the custom AutoFilter,” I want to make this important point: Although the Custom AutoFilter dialog box does enable you to filter a list based on two criteria, sometimes filtering operations apply to the same field. And if you need to apply more than two filtering operations to the same field, the only way to easily do this is to filter a filtered table.

Using advanced filtering

Most of the time, you’ll be able to filter table records in the ways that you need by using the Filter command or that unnamed table menu of filtering options. However, in some cases, you might want to exert more control over the way filtering works. When this is the case, you can use the Excel advanced filters.

Writing Boolean expressions

Before you can begin to use the Excel advanced filters, you need to know how to construct Boolean logic expressions. For example, if you want to filter the grocery list table so that it shows only those items that cost more than \$1 or those items with an extended price of more than \$5, you need to know how to write a Boolean logic, or algebraic, expression that describes the condition in which the price exceeds \$1 or the extended price exceeds or equals \$5.

See Figure 1-15 for an example of how you specify these Boolean logic expressions in Excel. In Figure 1-15, the range A13:B14 describes two criteria: one in which the price exceeds \$1, and one in which the extended price equals or exceeds \$5. The way this works, as you may guess, is that you need to use the first row of the range to name the fields that you use in your expression. After you do this, you use the rows beneath the field names to specify what logical comparison needs to be made using the field.

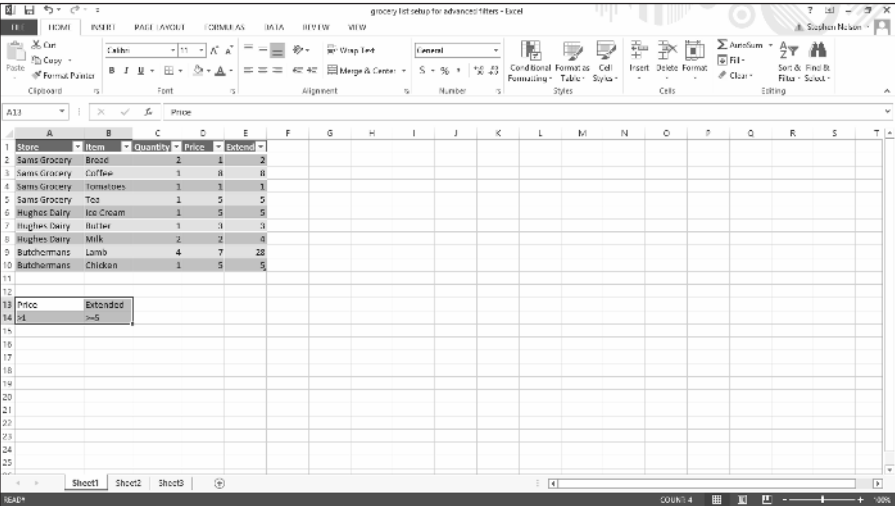

Figure 1-15:
A table
set up for
advanced
filters.

To construct a Boolean expression, you use a comparison operator from Table 1-2 and then a value used in the comparison.

| Table 1-2 | Boolean Logic |
|-----------|-----------------------------|
| Operator | What It Does |
| = | Equals |
| < | Is less than |
| <= | Is less than or equal to |
| > | Is greater than |
| >= | Is greater than or equal to |
| <> | Is not equal to |

In Figure 1-15, for example, the Boolean expression in cell A14 (>1), checks to see whether a value is greater than 1, and the Boolean expression in cell B14 (>=5) checks to see whether the value is greater than or equal to 5. Any record that meets *both* of these tests gets included by the filtering operation.

Here’s an important point: Any record in the table that meets the criteria in *any* one of the criteria rows gets included in the filtered table. Accordingly, if you want to include records for items that *either* cost more than \$1 apiece or that totaled at least \$5 in shopping expense (after multiplying the quantity times the unit price), you use two rows — one for each criterion. Figure 1-16 shows how you would create a worksheet that does this.

Figure 1-16:
A work-
sheet with
items that
meet both
criteria.

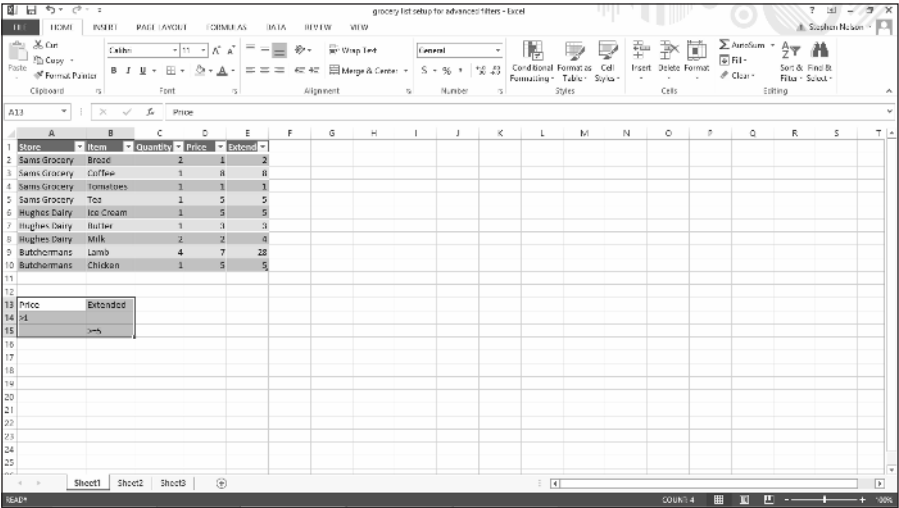

Running an advanced filter operation

After you set up a table for an advanced filter and the criteria range — what I did in Figures 1-15 and 1-16 — you're ready to run the advanced filter operation. To do so, take these steps:

1. Select the table.

To select the table, drag the mouse from the top-left corner of the list to the lower-right corner. You can also select an Excel table by selecting the cell in the top-left corner, holding down the Shift key, pressing the End key, pressing the right arrow, pressing the End key, and pressing the down arrow. This technique selects the Excel table range using the arrow keys.

2. Choose Data tab's Advanced Filter.

Excel displays the Advanced Filter dialog box, as shown in Figure 1-17.

Figure 1-17:
Set up an
advanced
filter here.

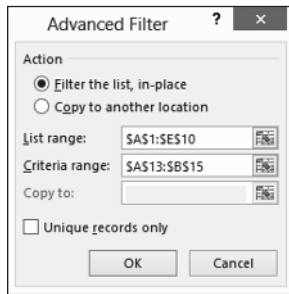

3. Tell Excel where to place the filtered table.

Use either Action radio button to specify whether you want the table filtered in place or copied to some new location. You can either filter the table in place (meaning Excel just hides the records in the table that don't meet the filtering criteria), or you can copy the records that meet the filtering criteria to a new location.

4. Verify the list range.

The worksheet range shown in the List Range text box — \$A\$1:\$E\$10 in Figure 1-17 — should correctly identify the list. If your text box doesn't show the correct worksheet range, however, enter it. (Remember how I said earlier in the chapter that Excel used to call these tables "lists"? Hence the name of this box.)

5. Provide the criteria range.

Make an entry in the Criteria Range text box to identify the worksheet range holding the advanced filter criteria. In Figure 1-17, the criteria range is \$A\$13:\$B\$15.

6. (Optional) If you're copying the filtering results, provide the destination.

If you tell Excel to copy the filter results to some new location, use the Copy To text box to identify this location.

7. Click OK.

Excel filters your list . . . I mean table. Figure 1-18 shows what the filtered list looks like. Note that the table now shows only those items that cost more than \$1 and on which the extended total equals or exceeds \$5.

| | A | B | C | D | E |
|----|---------------|-----------|----------|-------|----------|
| | Store | Item | Quantity | Price | Extended |
| 3 | Sains Grocery | Coffee | 1 | 8 | 8 |
| 5 | Sains Grocery | Tea | 1 | 5 | 5 |
| 6 | Hughes Dairy | Ice Cream | 1 | 3 | 3 |
| 7 | Hughes Dairy | Butter | 1 | 3 | 3 |
| 8 | Hughes Dairy | Milk | 2 | 2 | 4 |
| 9 | Butcherbarns | Lamb | 4 | 7 | 28 |
| 10 | Butcherbarns | Chicken | 1 | 5 | 5 |

Criteria: Price > \$1, Extended >= \$5

Status Bar: 7 OF 9 RECORDS FOUND

Figure 1-18:
The now-
filtered
results.

And that's that. Not too bad, eh? Advanced filtering is pretty straightforward. All you really do is write some Boolean logic expressions and then tell Excel to filter your table using those expressions.

