

IN THIS CHAPTER

- » Start an Office Application
- » Start a New Document
- » Explore the Office Ribbon and Tabs
- » Understand the File Menu (Backstage View)
- » Create a Document
- » Type Text
- » Insert a Picture
- » Move Around in a Document
- » Select Content
- » Zoom In and Out
- » Change the View

Chapter **1**

The Two-Dollar Tour

Step right up for a tour of Microsoft Office, the most popular suite of applications in the world!

Here are some of the things you can do with Office:

- » Write letters, reports, and newsletters.
- » Track bank account balances and investments.

- » Create presentations to support speeches and meetings.
- » Send and receive email.

The Office suite consists of several very powerful applications (programs), each with its own features and interface, but the applications also have a lot in common with one another. Learning about one application gives you a head start in learning the others.

In this chapter (and Chapter 2), I take you on a quick tour of some of the features that multiple Office applications have in common, including the tabbed Ribbon area. I also show you how to insert text and graphics in the various applications, and how to move around and zoom in and out.

In these first few chapters, I use Microsoft Word, PowerPoint, and Excel as the example applications because all of them work more or less the same way: They let you open and save data files that contain your work on various projects. Microsoft Outlook works a bit differently, as I show you in chapters 11 through 13.

Start an Office Application

Follow these steps to start an Office application:

1. Click the Start button in the lower-left corner of the Windows desktop, opening the Start menu.
2. Do any of the following (your choice!):
 - Look for a shortcut tile for the application on the right side of the Start menu. If you see one, click it.
 - Scroll down in the Start menu's left pane until you get to the section for the letter of the alphabet for the desired application (for example, P for PowerPoint) and click the application name.
 - Start typing the first few letters of the application name (for example, **po** for PowerPoint) and then click the application name on the filtered list that appears.

Start a New Document

When you open Word, Excel, or PowerPoint, a Start screen appears (no relation to the Windows Start menu), containing a list of recently used documents and thumbnail images of templates you can use to start new documents. To start a new blank document (which you'll want to do in order to follow along with this chapter), you can press the Esc key, or you can click the Blank template. The template has a slightly different name depending on the application; in Word it is called *Blank document*, in Excel it's *Blank workbook*, and so on. **Figure 1-1** shows the Start screen for Microsoft Word, for example.

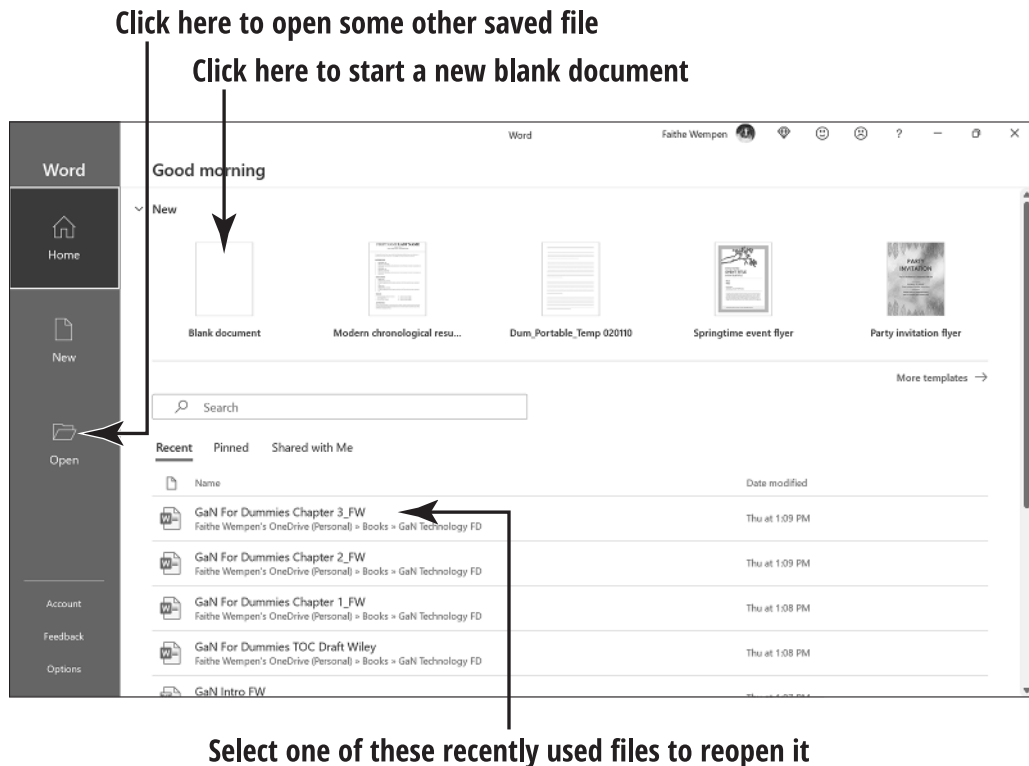

FIGURE 1-1

To create an additional new blank document after the application is already up and running, press **Ctrl+N** at any time.



TIP

Office 2010 and earlier started a blank document automatically in Word, Excel, and PowerPoint, without having to go through a Start screen. If you want that old-style behavior back, click File and then click Options. On the General page, scroll down to the bottom and deselect the Show the Start Screen When This Application Starts check box.

Explore the Office Ribbon and Tabs

All Office applications have a common system of navigation called the *Ribbon*, which is a tabbed bar across the top of the application window. Each tab is like a page of buttons. You click different tabs to access different sets of buttons and features.

Figure 1-2 shows the Ribbon in Microsoft Word with the Home tab displayed. Within a tab, buttons are organized into groups. In **Figure 1-2**, the Home tab's groups are Clipboard, Font, Paragraph, Styles, Editing, Voice, and Editor.

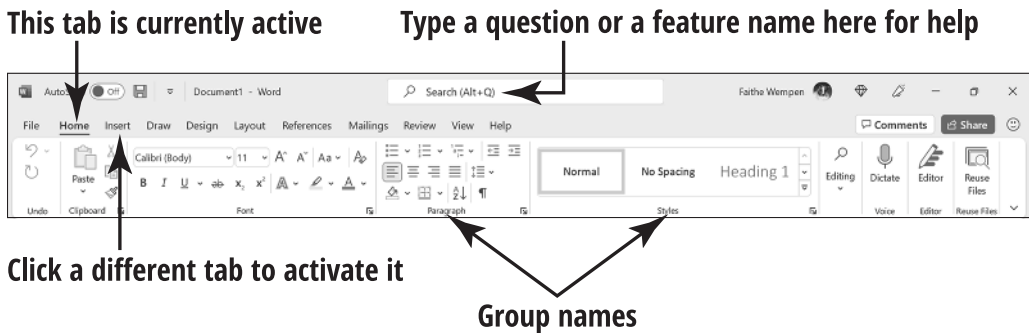

FIGURE 1-2

Each Office application has a set of tabs for the tasks it performs. For example, Word has a Mailings tab that holds the commands for doing mail merges. Excel has a Formulas tab that holds the commands for setting up calculations.



TIP

If you run Office applications on a device that has a touchscreen, you get an extra tab on the Ribbon: Draw. This contains tools for drawing with a finger or a stylus. You can also manually enable this tab by customizing the Ribbon, as explained in Chapter 19.



TIP

You might find tabs that were added by *third-party* (non-Microsoft) software. For example, if you have a program called Adobe Acrobat installed, you might have an Acrobat tab in each of the Office applications. Certain templates also add custom tabs and buttons to the Ribbon.

The buttons and controls on the tabs operate in different ways. **Figure 1-3** points out some examples on Word's Home tab.

- » **On/off toggles:** Each time you click the button, it switches between on and off. When a feature is on, the button's appearance changes (for example, it might look shaded in comparison to the other buttons).
- » **Command buttons:** When you click the button, the command executes. If you click a command button again, the command repeats.
- » **Connected button sets:** In connected sets of buttons, selecting a button deselects (cancels) the previous selection in the set.
For example, Figure 1-3 has four buttons in the bottom row for paragraph alignment. The leftmost one is selected; if you click one of the others, it's automatically canceled.
- » **Menu buttons:** Buttons with arrows on them open menus or color palettes.
- » **Galleries:** A *gallery* is like a permanently open menu or palette; click a selection directly from a gallery. Most galleries also have a More button that shows more choices.

You can hover the mouse pointer over a button to see a pop-up box, called a *ScreenTip*, which tells the button's name and/or purpose.

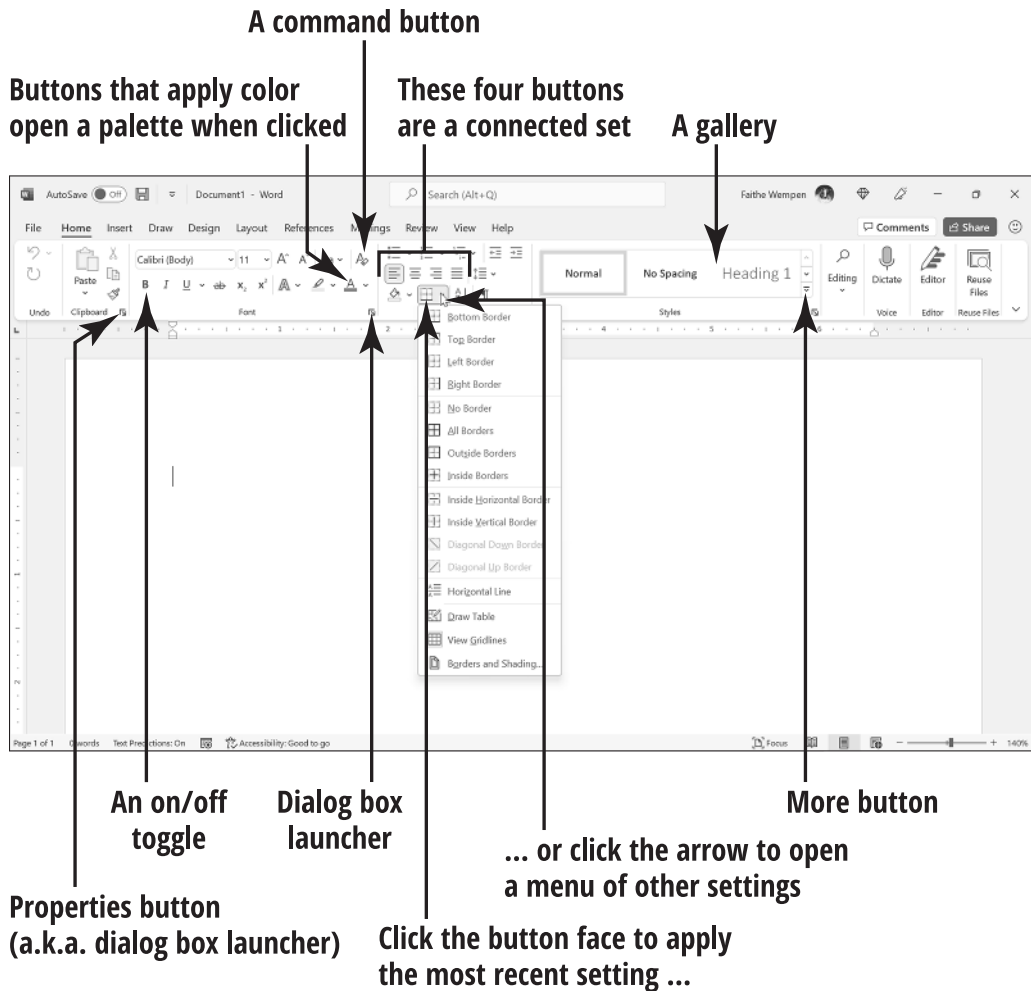

FIGURE 1-3

With some buttons that contain arrows, you can click anywhere on the button face — directly on the arrow or not — to open the menu or *palette* (an array of colored squares from which you can choose a color). With others, the button face and the arrow are separate clickable areas. Clicking the arrow opens the menu, but clicking the button face applies whatever setting was most recently chosen from the menu.



To tell the difference between the two types of menu buttons, point the mouse at the button. If the button face and the arrow are different colors or if there is a thin line between them, it's the type where you have to click directly on the arrow to get the menu. If there's no separation, you can click anywhere on the button.

In the bottom-right corner of many of the groups is a small square with an arrow. Clicking this square (called a *dialog box launcher* or a *properties button*) opens a dialog box related to that group. For example, the one for the Font group in Figure 1-3 opens the Font dialog box, which contains controls for every button in that group plus more options not available on the Ribbon.

Not sure which tab contains the command you want, or what the command is called? The Search box (shown in Figure 1-2) enables you to ask questions in plain English. Just type your question in the box and press Enter to see a list of relevant commands and help information, and then click the one you want to issue that command.

When you resize the application's window so the window is narrower than normal, or when you run the application on a computer that has low-resolution video settings, the controls on the Ribbon *compress* (squeeze together). Some of the groups turn into single buttons with drop-down lists for accessing the individual controls within that group. For example, in **Figure 1-4**, the Editing group is compressed, and has been opened as a drop-down list.



TIP

Above the main part of the Ribbon is a small toolbar called the *Quick Access Toolbar (QAT)*. You can add buttons for frequently used commands here (as many as you can fit). To add a button to the QAT, right-click any control from any tab and choose Add to Quick Access Toolbar, as shown in **Figure 1-5**. To change the position of the Quick Access Toolbar, right-click it and choose Show the Quick Access Toolbar Below the Ribbon (or Above, if it's already below).

Click a button for a collapsed group ...

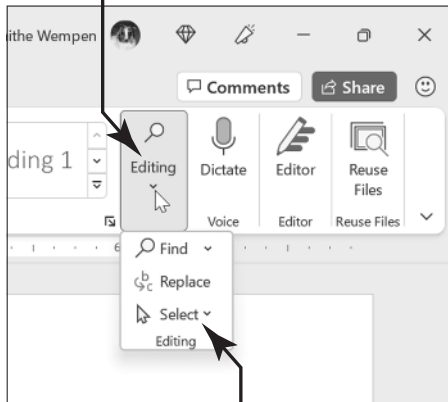

... to expand the group and select a command from it

FIGURE 1-4

Quick Access Toolbar Right-click any control on any tab to add it to the Quick Access Toolbar

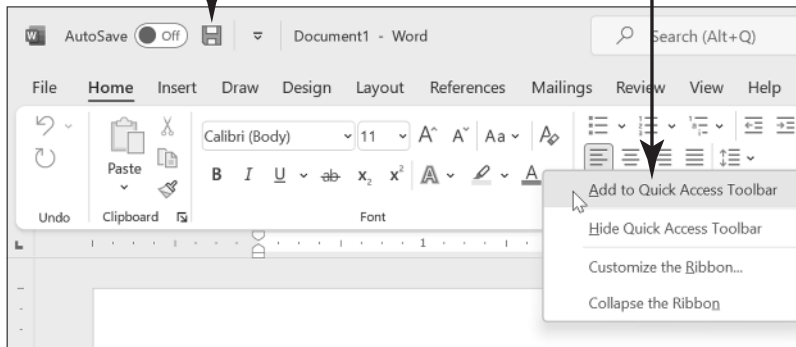

FIGURE 1-5



TIP

Depending on how your system is set up, it's possible that the QAT might be below the Ribbon rather than above it. If it appears below the Ribbon and you want it above, click the down arrow at the right end of the QAT and choose Show Above the Ribbon.

Check out Chapter 19 to learn more about customizing the QAT, as well as the Ribbon itself.

In some Office apps, the QAT might not appear at all. If you don't see it but you want to, click the down arrow at the far right end of the Ribbon to open a menu and choose Show Quick Access Toolbar.

Understand the File Menu (Backstage View)

Clicking the File tab opens the File menu, also known as *Backstage view*. Backstage view provides access to commands that have to do with the data file you are working with — things like saving, opening, printing, mailing, and checking its properties. The File tab is a different color in each application. In Word, for example, it is blue. To leave Backstage view, click some other tab or press the Esc key.

Backstage view lists top-level categories in a navigation pane at the left; click one to see the commands available. The content to the right of the category list depends on what you have chosen.

When a document is open and you enter Backstage view, the Info category appears. It provides information about the current document, and offers commands for protecting the document, checking for issues, and managing versions. See **Figure 1-6**. In addition, if the document uses a different file format than the latest one, a Convert button appears, enabling you to upgrade to the newest format. (It doesn't appear in Figure 1-6.)

The bottom-most command in the navigation pane in Backstage view is Options, which opens a dialog box from which you can control the settings for the application. Chapter 19 explains some of the settings you can change.

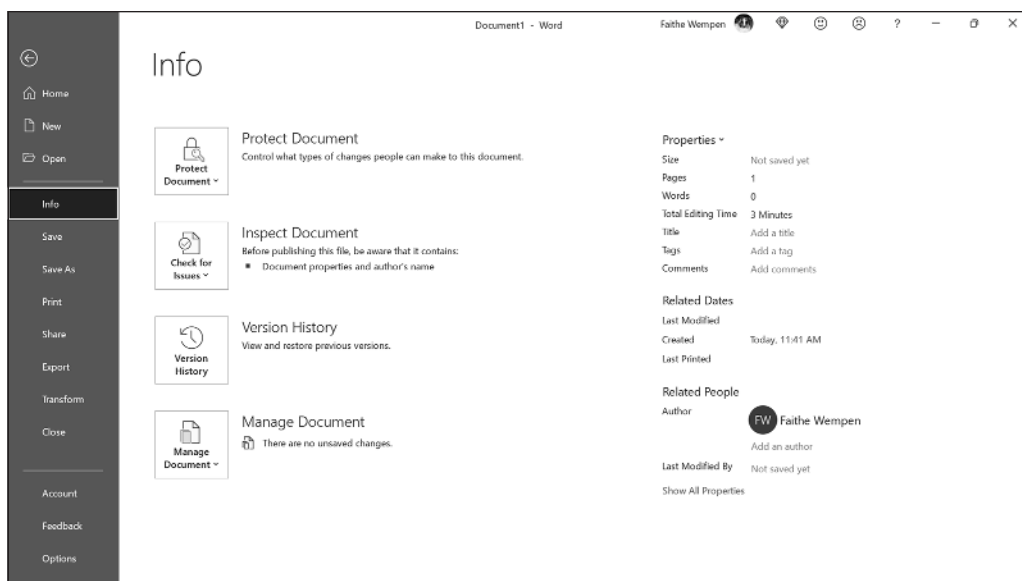

FIGURE 1-6

Create a Document

In Word, Excel, and PowerPoint, the Start screen appears when you start the application, and from there you can create a new document (or workbook, or presentation) by pressing the Esc key or clicking the Blank template. You can then just start typing or inserting content into it.

You can also create additional new documents at any time. An easy shortcut is to press Ctrl+N. You can also choose File → New. That latter method has the advantage of opening a selection of templates you can use to jumpstart your work if you don't want a totally blank document to start with. Choose one of the templates that appears, or click in the Search for Online Templates box, type a keyword, and then press Enter to look for a certain kind of template. Let's forego the templates for now, though, and keep working in this chapter with a blank document.

Type Text

Putting text on the page (or on-screen) is a little different in each of the three major Office applications: Word, Excel, and PowerPoint.

- » **Word:** The main work area of the program is a blank slate on which you can type directly. Just click in the work area and start typing! Chapter 2 explains more about typing and editing text. See **Figure 1-7**.
- » **Excel:** The work area is divided into a grid of cells. Click any cell to make it active, and type to place text into it, as in **Figure 1-8**. Chapter 7 shows how to work with text in Excel cells.
- » **PowerPoint:** The work area is divided into two panes. The larger one, on the right, is where you insert content on a slide.
 - If a slide has a text placeholder on it, you can click in the placeholder and type, as in **Figure 1-9**.

In Word, there is a single work area

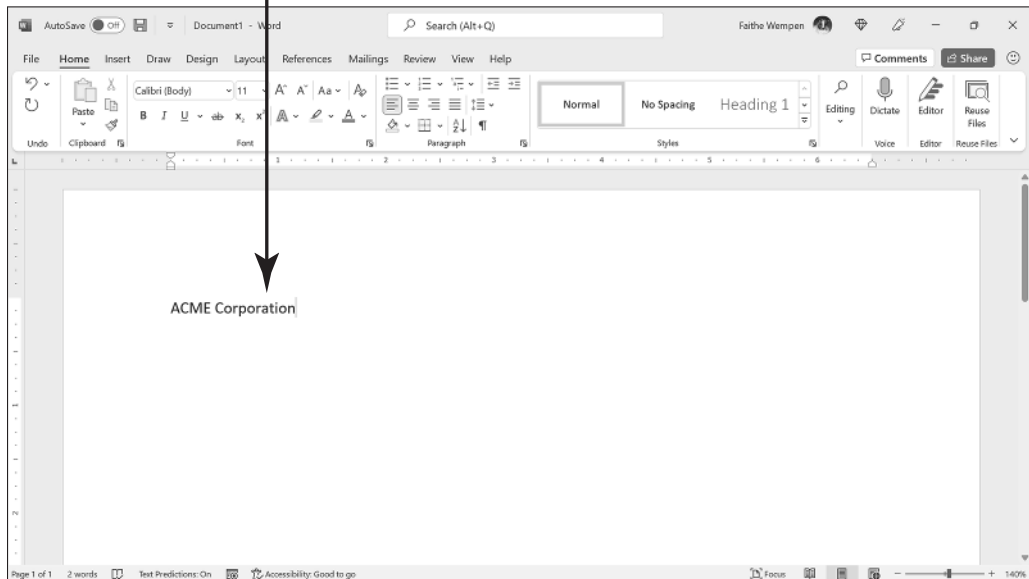

FIGURE 1-7

In Excel, text is entered in individual cells

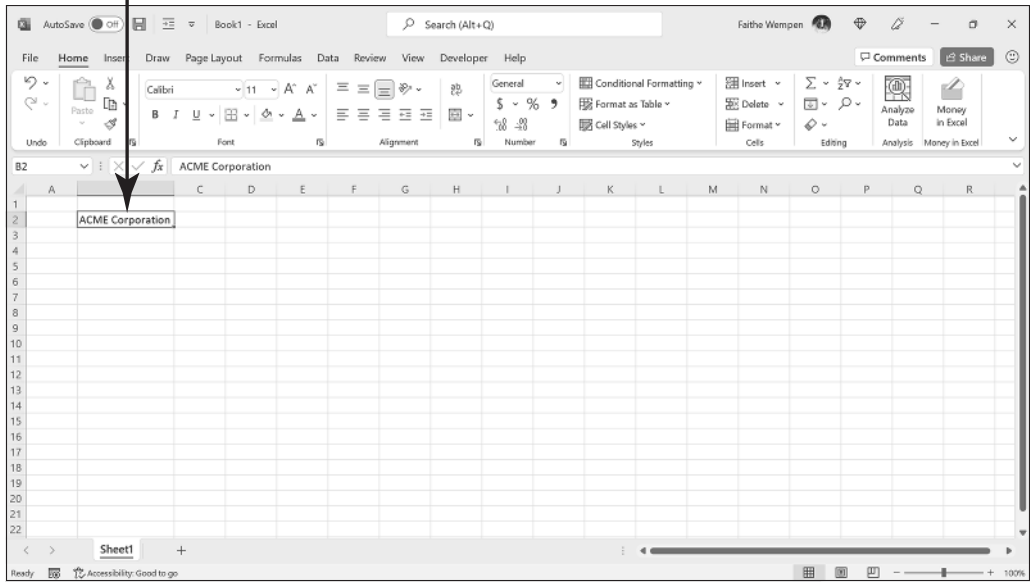

FIGURE 1-8

In PowerPoint, text is entered in placeholder boxes on slide layouts

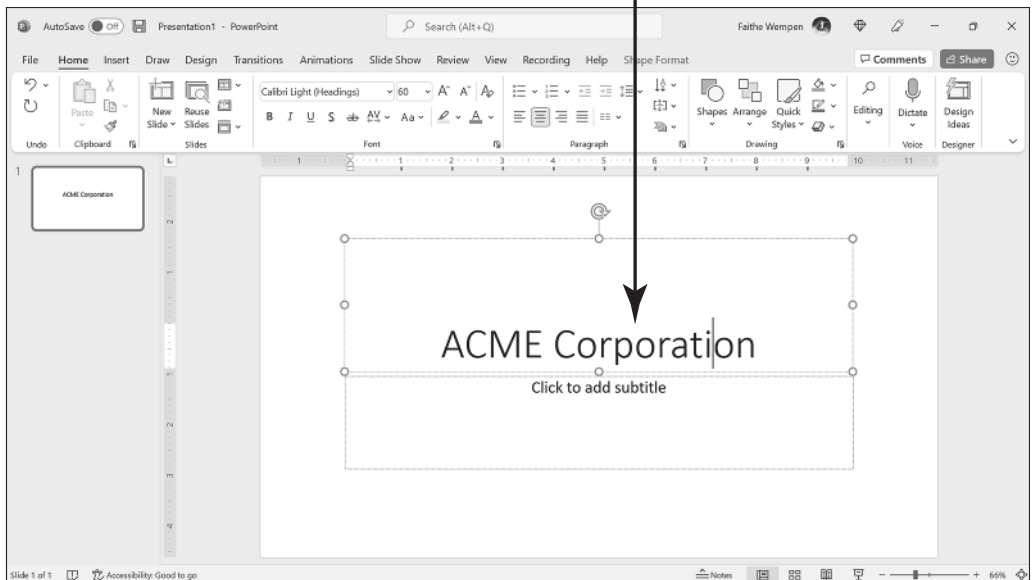

FIGURE 1-9

- If there isn't a placeholder on the slide, or if the placeholder doesn't meet your needs, you can place a text box on the slide manually. (That's covered in Chapter 11.)

Insert a Picture

All Office applications accept various types of pictures. Here's how to insert a photo (or other graphic file) into Word, Excel, or PowerPoint:

1. Click the Insert tab.
2. Click the Pictures button.

A menu opens containing three options: This Device, Stock Images, and Online Pictures.

3. Click This Device.

The Insert Picture dialog box opens. See **Figure 1-10**. The default location that opens is the Pictures folder for the user currently signed into Windows.

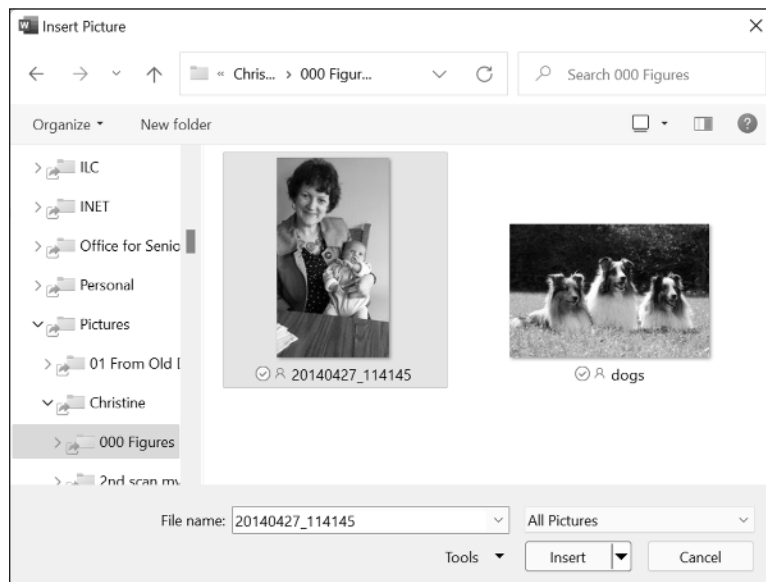

FIGURE 1-10

4. Select the picture you want to insert. (You might need to change to a different location. Navigating between locations in a dialog box is covered in Chapter 3.)
5. Click the Insert button.

The preceding steps apply to picture files, such as images from a digital camera or that you downloaded from the Internet. There are lots of other graphic types, such as online images, WordArt (stylized text), and drawn lines and shapes. Each of these has its own procedure for insertion. Later chapters discuss these in more detail.



TIP

You can drag and drop pictures directly from File Explorer into any document in an Office application.

Move Around in a Document

As you add content in one of the applications, there might be so much content that you can't see it all on-screen at once. You might need to scroll through the document to view different parts of it.

The simplest way to move around is by using the scroll bars with your mouse:

- » In Excel, vertical (up and down) and horizontal (left to right) scroll bars are always available.
- » In Word and PowerPoint, the vertical scroll bar is always available. The horizontal scroll bar disappears if there is no undisplayed text from side to side.

Figure 1-11 shows several ways to use a scroll bar:

- » Click the arrow at the end of a scroll bar to scroll the display slowly in the direction of the arrow (a small amount each time you click).
- » Drag the box in the scroll bar to scroll quickly.

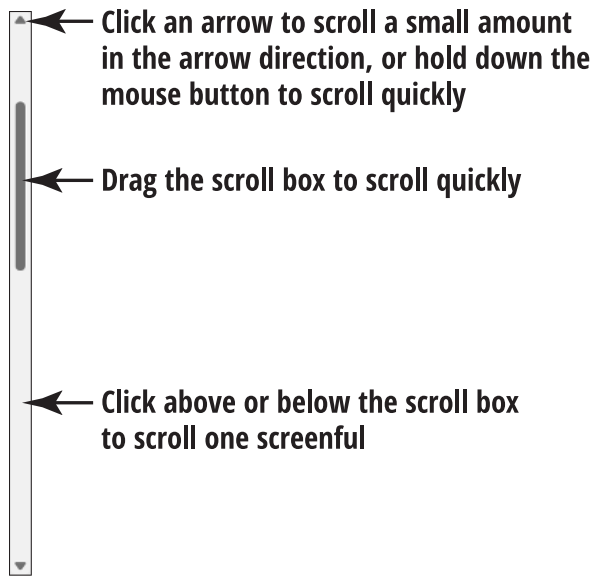

FIGURE 1-11

» Click in the empty space on the bar to one side or the other of the scroll box to move one screenful at a time in that direction.



TIP

The size of the scroll box (the blank rectangle you drag in the scroll bar) indicates how much content you can't see at the moment. For example, in Figure 1-11, the scroll box occupies about one-half of the scroll bar; this means that there is about one screenful of undisplayed content. In a very large spreadsheet, the scroll box might be very small. If you have a wheel on your mouse, you can also scroll vertically by rolling the wheel.



TIP

You can also move around by using keyboard shortcuts. As you gain experience with the applications, you might find using keyboard shortcuts more convenient than using the scroll bar. Chapter 4 lists shortcuts for Word, Chapter 7 lists shortcuts for Excel, and Chapter 14 lists shortcuts for PowerPoint.

Select Content

Selecting content is an essential skill for any Office application. Many commands in Office applications apply to whatever text or graphics you select. For example, to make some text bold, select it first, and then click the Bold button. **Figure 1-12** shows some selected text.

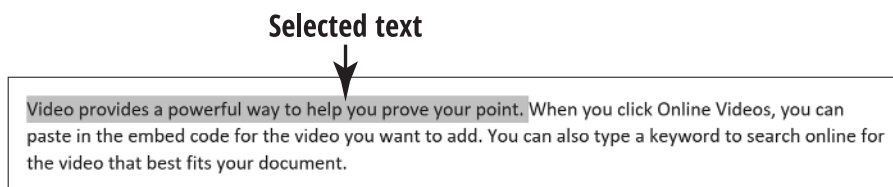

FIGURE 1-12

To select text in Word or PowerPoint, you can either

- » Drag the mouse pointer across it (holding down the left mouse button)
- or
- » Click where you want to start and then hold down Shift as you press the arrow keys to extend the selection.

When text is selected, its background changes color (usually gray or light blue, but it depends on the color scheme in use).

In Excel, you usually want to select entire cells rather than individual bits of text; when the cell is selected, any formatting or other commands that you issue applies to everything in that cell. To select a cell, click it. You can extend the selection to multiple cells by dragging across them or by holding down Shift and pressing the arrow keys.



TIP

You can also select text by using keyboard shortcuts. Chapter 4 lists shortcuts for Word, Chapter 7 lists shortcuts for Excel, and Chapter 14 lists shortcuts for PowerPoint.

To select a graphic, click it with the mouse. Selection handles (white squares) appear around the outside of it. **Figure 1-13** shows a selected graphic in Word.

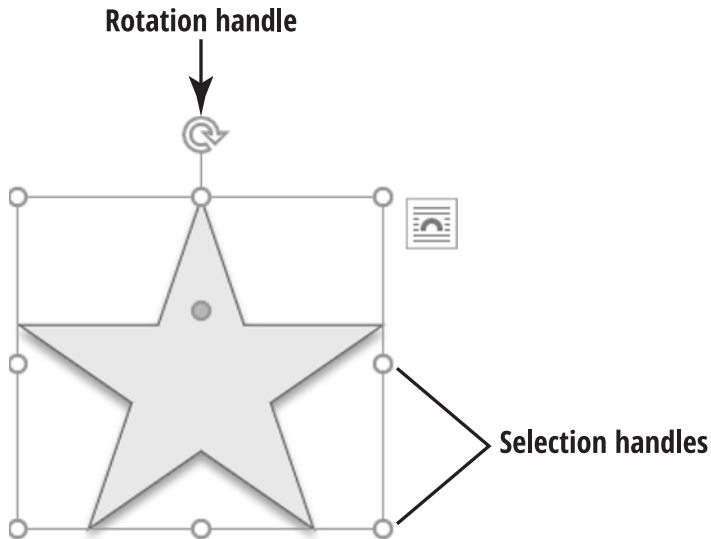

FIGURE 1-13

When a graphic is selected, you can do any of the following to it:

- » **Move it.** Position the mouse pointer on the graphic (not on the border) and drag.
- » **Copy it.** Hold down the Ctrl key while you move it.
- » **Resize it.** Position the mouse pointer on one of the selection handles and drag.
- » **Delete it.** Press the Delete key.
- » **Rotate it.** Drag the rotation handle, which is the circular arrow above the graphic.

Zoom In and Out

While you're working in an Office application, you might want to zoom in to see a close-up view of part of your work, or zoom out to see a bird's-eye view of the whole project. The lower the zoom percentage, the smaller everything looks — and the more you can see on-screen at once, without scrolling.

Word, Excel, and PowerPoint all have the same zoom controls, located in the bottom-right corner of the application window. (There are also zoom controls on the View tab in each application.) **Figure 1-14** shows the zoom controls on the status bar.

- » Drag the slider to adjust the zoom (to the left to zoom out and to the right to zoom in).
- » Click the minus or plus button (at opposite ends of the slider) to slightly zoom out (minus) or in (plus).
- » Clicking the number of the current zoom percentage opens a Zoom dialog box, which shows more zooming options.

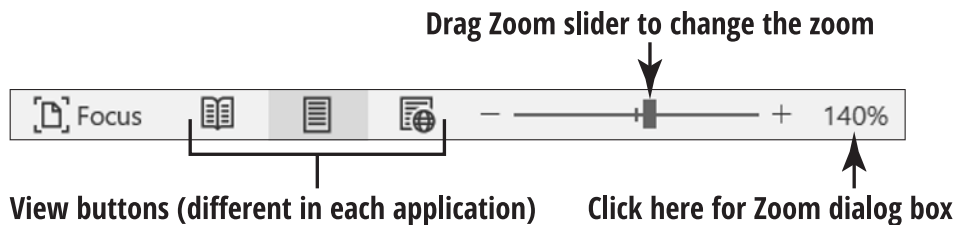

FIGURE 1-14



TIP

Zooming doesn't affect the size of printouts. It is only an on-screen adjustment.

Change the View

Each Office application has a variety of viewing options available. Each view is suited for a certain type of activity in that application. For example, in Word, you can choose Draft view, which is speedy to work with and presents the text in a simple one-column layout. Or you can choose a Print Layout view, where you can see any special layout formatting you applied, such as multiple columns. To change to a different view, select it from the View tab on the Ribbon.

These views are available:

» Word

- *Read Mode*: Optimizes the display for on-screen reading. You cannot edit the document in this view.
- *Print Layout*: Shows the document approximately as it will be printed, including any layout features, such as multiple columns.
- *Web Layout*: Displays the document as it will appear if saved as a webpage and published on a website.
- *Outline*: Displays the document as an outline, with headings as outline levels.
- *Draft*: Displays the document in simple text form, in a single column.

» Excel

- *Normal*: Displays a regular row-and-column grid.
- *Page Break Preview*: Shows a zoomed-out version of the worksheet with page break lines that you can drag to adjust where they fall.
- *Page Layout*: Displays the content as it will appear on a printed page.

» PowerPoint

- *Normal*: This default view provides multiple panes for working with the content.
- *Outline*: The same as Normal view, except instead of thumbnails of each slide you see a text outline of slide content.
- *Slide Sorter*: All of the slides appear as thumbnail images, which is useful for rearranging the order of slides.
- *Notes Page*: Each slide appears as a graphic on a page where notes are displayed.
- *Reading View*: Similar to Slide Show view, except in a floating window rather than full screen.
- *Slide Show*: The presentation is shown to the audience, one slide at a time. The Slide Show view controls appear on the Slide Show tab, rather than on the View tab with the other views.

In addition to the view buttons on the View tab, each application has shortcut buttons to a few of the most common views. You can find these buttons to the left of the Zoom slider, as pointed out in Figure 1-14. Hover your mouse over a button to find out which view it selects.

Enjoying the tour so far? There's lots more ahead in Chapter 2, where I continue walking you through the important features that the Office apps have in common.